

Pinces tirées - Zugspannzangen - Pull-type collets

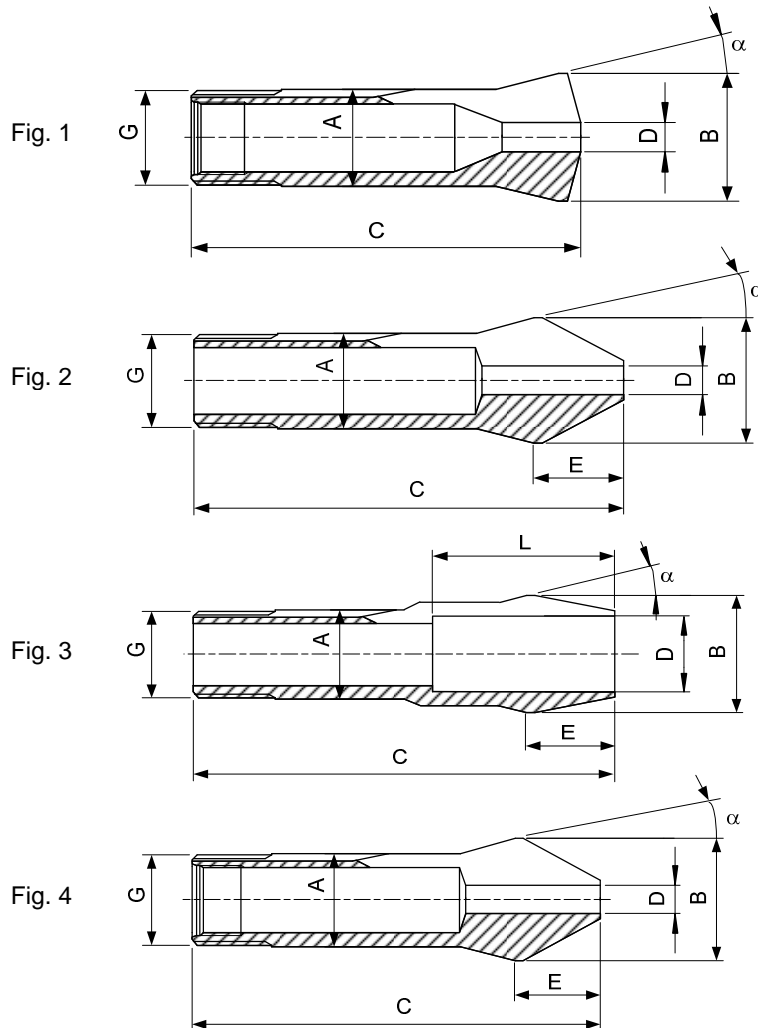

Alésage à cran
 Stufenbohrung
 Step bore

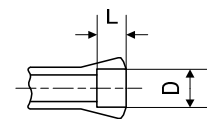

Type	Art.	A	B	C	E	G	α	D min-max		L	Fig.
W25	80-92872 10) 80-5	25	33.7	112.2	19.7	\emptyset 24.7x1.693	∇ 45°/5°	15°	0.30...19.05	-	2
	80-2006 10) 80-5	25	33.7	112.2	19.7	\emptyset 24.7x1.693	∇ 45°/5°	15°	19.06...21.00	50	3
	80-93837 26) + 10) 80-5	25	33.7	112.2	19.7	\emptyset 24.7x1.693	∇ 45°/5°	15°	Morse DIN228	-	2
	80-93838 26) + 10) 80-5	25	33.7	112.2	19.7	\emptyset 24.7x1.693	∇ 45°/5°	15°	Morse DIN228	-	2
W31.75	80-842	31.75	37.4	87	-	\emptyset 31.4x1.27	∇ 60°	10°3'	0.50...25.19	-	1
	80-2007 10) 80-842	31.75	37.4	108.7	25.4	\emptyset 31.4x1.27	∇ 60°	10°3'	25.20...27.99	40	
									28.00...28.99	10	
									29.00...29.99	7	
									30.00...31.00	4	
									0.30...25.19	-	4
									25.20...28.00	64	

Alésages standards (rond, carré, six-pans) selon liste de prix. Autres alésages sur demande.
 Standardbohrungen (rund, vierkant, sechskant) gemäss Preisliste. Andere Bohrungen auf Anfrage.
 Standard bores (round, square, hexagonal) according to price list. Other bores on request.

10) Article de base - Basisartikel - Basic item
 26) Sur demande - Auf Anfrage - On request