

**Pinces - Spannzangen - Collets ESX, EX**

**ESX (DIN 6499-B)**

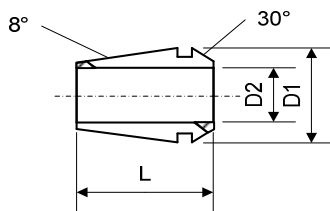

qualité standard  
 Qualität Standard  
 quality standard

avec plage de serrage (S) vers le bas  
 mit Spannbereich (S) nach unten  
 with compression (S) inwards

**EX (DIN 6499-A)**

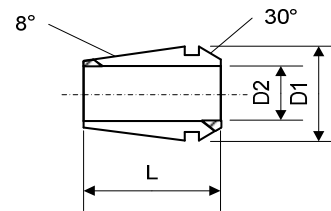

qualité UP  
 Qualität UP  
 quality UP

serre le diamètre nominal  
 spannt den Nenndurchmesser  
 clamps the nominal diameter

| Gr.        | Art.     | D1 | D2            | L    | S        | Gr.        | Art.     | D1    | D2     | L    |
|------------|----------|----|---------------|------|----------|------------|----------|-------|--------|------|
| ESX9       | 75-9300  | 9  | 1-5           | 14.5 | 0.5      | EX9        | 75-9200  | 9     | 0.5-5  | 14.5 |
| ESX12      | 75-12300 | 12 | 1-3<br>4-7    | 19.5 | 0.5<br>1 | EX12       | 75-12200 | 11.75 | 0.5-7  | 17.5 |
| ESX16      | 75-16300 | 17 | 1-1.5<br>2-10 | 27.5 | 0.5<br>1 | EX16       | 75-16200 | 16.7  | 0.3-10 | 27.5 |
| DIN 6499-B |          |    |               |      |          | DIN 6499-A |          |       |        |      |
| ESX20      | 75-20300 | 21 | 1-1.5<br>2-13 | 31.5 | 0.5<br>1 | EX20       | 75-20200 | 20.7  | 1-13   | 31.5 |
| DIN 6499-B |          |    |               |      |          | DIN 6499-A |          |       |        |      |
| ESX25      | 75-25300 | 26 | 1-1.5<br>2-16 | 34   | 0.5<br>1 | EX25       | 75-25200 | 25.7  | 1-16   | 34   |
| DIN 6499-B |          |    |               |      |          | DIN 6499-A |          |       |        |      |
| ESX32      | 75-32300 | 33 | 2.5<br>3-20   | 40   | 0.5<br>1 | EX32       | 75-32200 | 32.7  | 2-20   | 40   |
| DIN 6499-B |          |    |               |      |          | DIN 6499-A |          |       |        |      |
| ESX40      | 75-40300 | 41 | 3-26          | 46   | 1        | EX40       | 75-40200 | 40.7  | 3-26   | 46   |
| DIN 6499-B |          |    |               |      |          | DIN 6499-A |          |       |        |      |